

UT372D 2 in 1 Tachometer Quick Start Guide

UT372D is a tachometer that has contact and non-contact RPM measurement modes. Here is a quick start guide for this product.

1. Battery Installation

- Loosen the quick release screw on the rear housing and remove the battery cover;
- Install the new batteries and be sure that the polarity is correct;
- Close the battery cover and tighten the quick release screw.

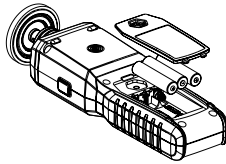

2. Contact---RPM/Hz

- Install the mechanical adapter and tighten the quick release screws;
- Install the cone/internal cone shaft contact;
- Turn on the tachometer > Select the contact measurement mode > Select the unit RPM or Hz;
- Make the shaft contact closely contact with the object to be measured and start measuring.

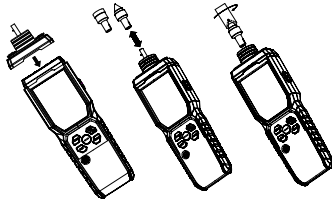

3. Contact---Surface Velocity/Length Measurement

- Install the mechanical adapter and tighten the quick release screws;
- Install the contact wheel (0.1m/6in);
- Turn on the tachometer > Select 0.1m or 0.6in according to the contact wheel used > Select the surface velocity unit (m/min, in/min, ft/min) or length unit (m, in, ft);
- Make the contact wheel closely contact with the object to be measured and start measuring.

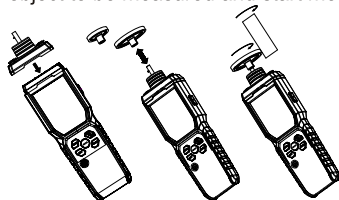

4. Non-Contact---RPM/Hz

- Loosen the quick release screws of the mechanical adapter and remove the adapter;
- Cut a piece of 10mm*10mm reflecting tape and stick it on the measured object, and tear off the film on the surface of the reflecting tape.
- Turn on the tachometer > Select the non-contact measurement mode > Select the unit RPM or Hz;
- Press the Measure button to turn on the laser. Point the laser vertically at the reflecting tape and start measuring.

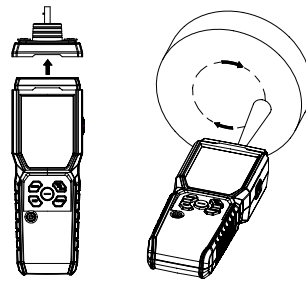

5. Non-Contact---REV

- Loosen the quick release screws of the mechanical adapter and remove the adapter;
- Turn on the tachometer > Select the non-contact measurement mode > Select the unit REV;
- Press the Measure button to turn on the laser. Point the laser vertically at the passing objects and start counting.

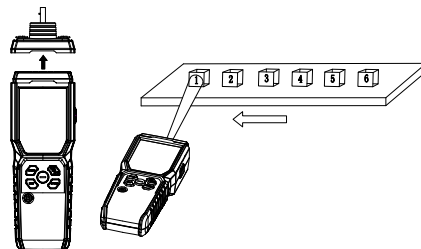

UNI-T®
UNI-TREND TECHNOLOGY (CHINA) CO., LTD.

No. 6, Gong Ye Bei 1st Road,
Songshan Lake National High-Tech Industrial
Development Zone, Dongguan City,
Guangdong Province, China

